



7/30 Henry Street Payneham SA

2 1 2

This unit is a standout with its spacious living areas, separate lounge, generous dining and renovated kitchen.

The living areas feature soaring raked ceilings with ski-high windows that bring in an abundance of natural light. The architecture feels modern, spacious and bright.

Perfectly positioned close to the city, main transport routes and walking distance to Marden shopping centre, Payneham Oval and an abundance of restaurants. This immaculately presented home will delight the astute buyer.

Two generous bedrooms are well positioned and separate from each other, and there is a modernised bathroom and separate toilet and separate laundry.

A cute paved courtyard garden is a good place to entertain

View : <https://www.alexanderrealestate.com.au/sale/sa/eastern-suburbs/payneham/residential/unit/7260141>



Steve Alexander
0411 755 985



Bonnie Whyte
0409 300 195

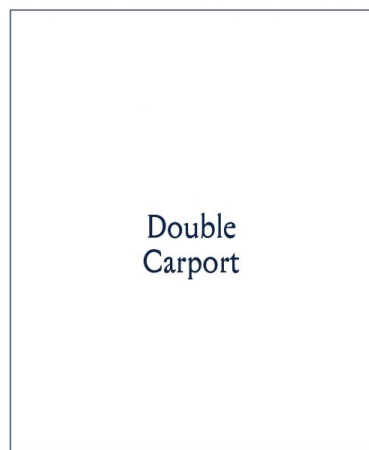
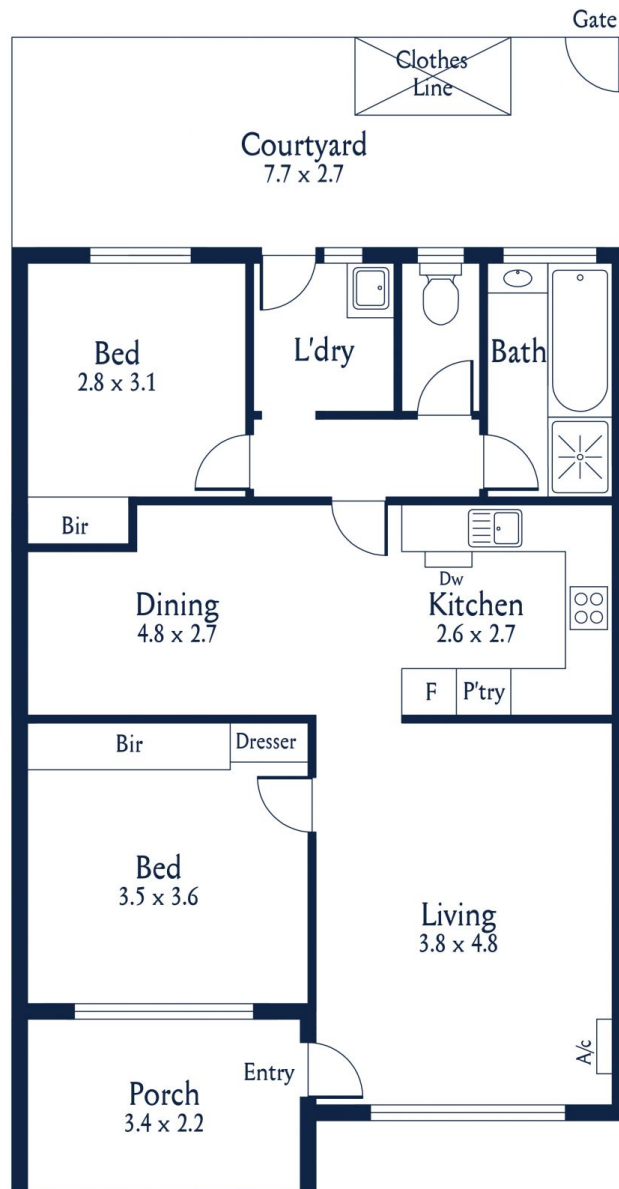

Internal	- 73.8 SQM
External	- 55.1 SQM
Total	- 128.9 SQM