



## 7 Rothbury Avenue Heathpool SA

4 🏠 2 🚗 2 🚗

The home's formal entry through double leadlight decorated glass doors opens to a large foyer with an anchoring pendant light and two more sets of original French double doors drawing you through the home.

The expansive formal living room has an ornate gas fireplace with Art Deco mantle, curved features and rendered brick, which opens through to the formal dining, both rooms with stunning Jarrah timber floors. The living room has a character box bay window seat and picturesque views over the front garden. A sunroom to the side of the dining room is a perfect quiet study spot. There are 4 generous bedrooms, all with built-in robes and two-family bathrooms, the main with a luxurious bath and double basin with stone benchtops and floor to ceiling white tiles.

**Land Size** : 1137 sqm  
**View** : <https://www.alexanderrealestate.com.au/sale/sa/eastern-suburbs/heathpool/residential/house/7260159>



**Steve Alexander**  
0411 755 985



**Bonnie Whyte**  
0409 300 195

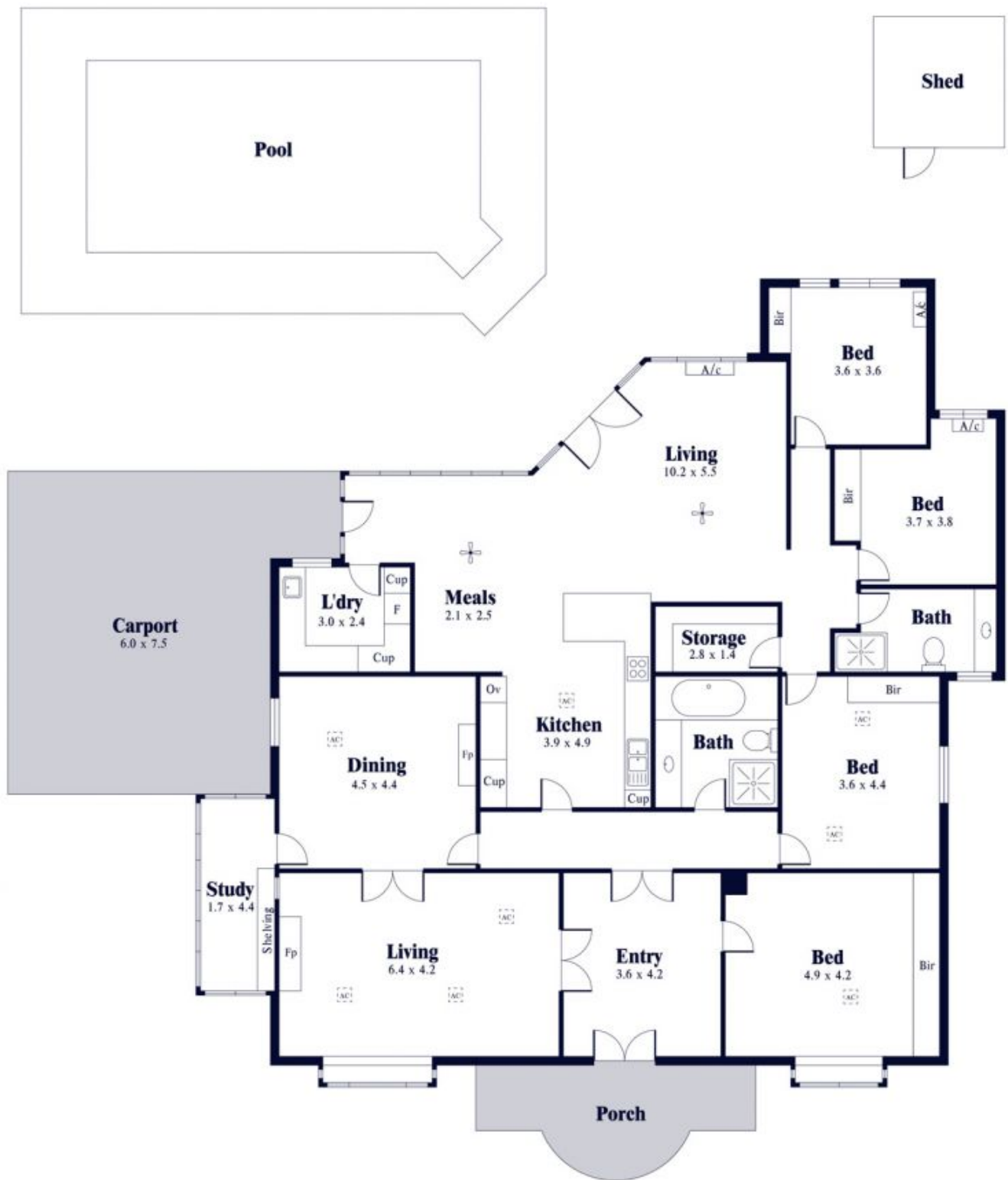

Internal - 254.1 SQM  
 External - 69.0 SQM  
 Total - 323.1 SQM

