

35 Charles Street Unley SA

2 1 2

*Offers close Monday 22nd August @5pm (USP)

Located in the sought-after city fringe suburb of Unley, this sandstone fronted character cottage provides an outstanding opportunity to secure a convenient and low maintenance lifestyle with every convenience at your doorstep.

Proudly boasting character features throughout, including polished floorboards, lofty ceilings, pretty leadlight, ornate hallway and original fireplaces, this delightful cottage is ready for the new owners to move in and make their own.

What we love:

?Two spacious bedrooms both with original fireplaces, built-in robes & ceiling fans

?Polished Baltic pine board throughout

?3.3m high ceilings

Land Size : 257 sqm

View : <https://www.alexanderrealestate.com.au/sale/sa/eastern-suburbs/unley/residential/house/7260245>



Bonnie Whyte
0409 300 195

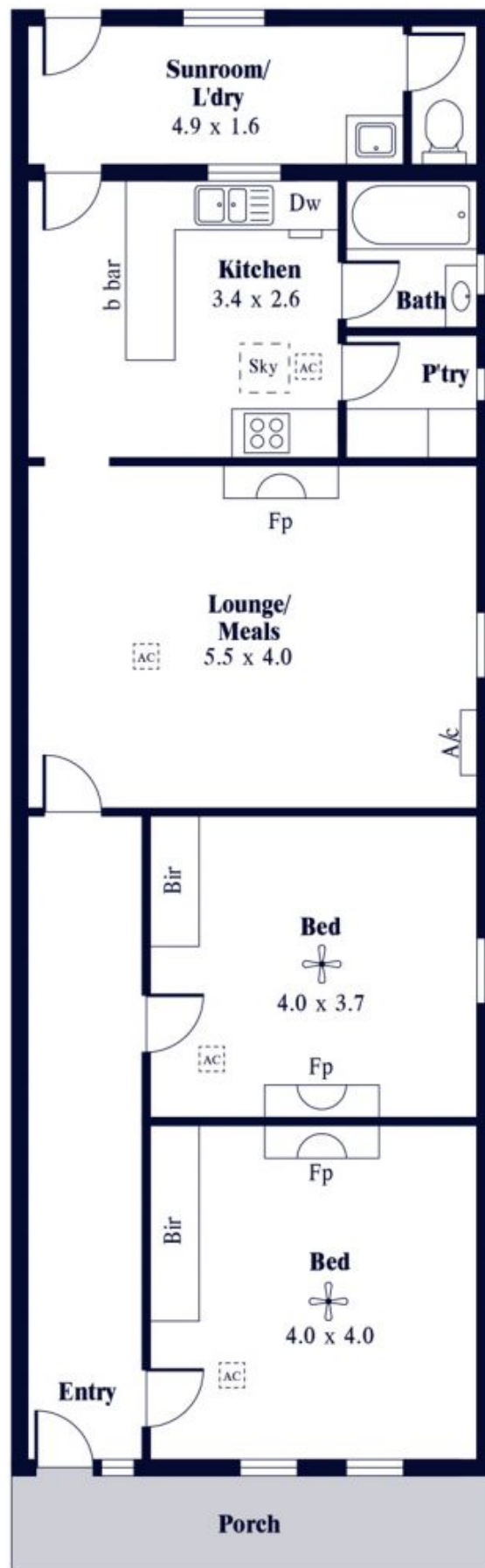

Internal - 95.5 SQM
 External - 7.0 SQM
 Total - 102.5 SQM

