

18 Hillside Road Aldgate SA

4 2 5

Drawing on the Balinese building tradition of a floorplan encompassing separate pavilions to serve different functions, this home cleverly defines each living zone for practical use for today's modern family.

From the road, the automated gate draws back to reveal a multi-level botanic-like garden of grand proportions. The lower-level motor court provides off-street and double, side-by-side garaging for guests, or take the curved ascending driveway, past the hand-laid stone walls and manicured gardens to arrive at house-level, where you'll find a 3-vehicle carport.

If you choose the garden's central stone staircase as your entry point, you will arrive at the formal entrance, a magnificent spot to take in the spectacular elevated views over the garden. Over-sized timber eaves shelter the front of

Land Size : 3679 sqm
View : <https://www.alexanderrealestate.com.au/sale/sa/adelaide-hills/aldgate/residential/house/7725410>

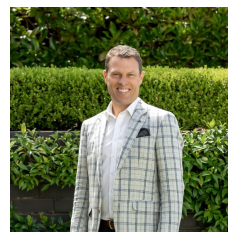

Steve Alexander
 0411 755 985

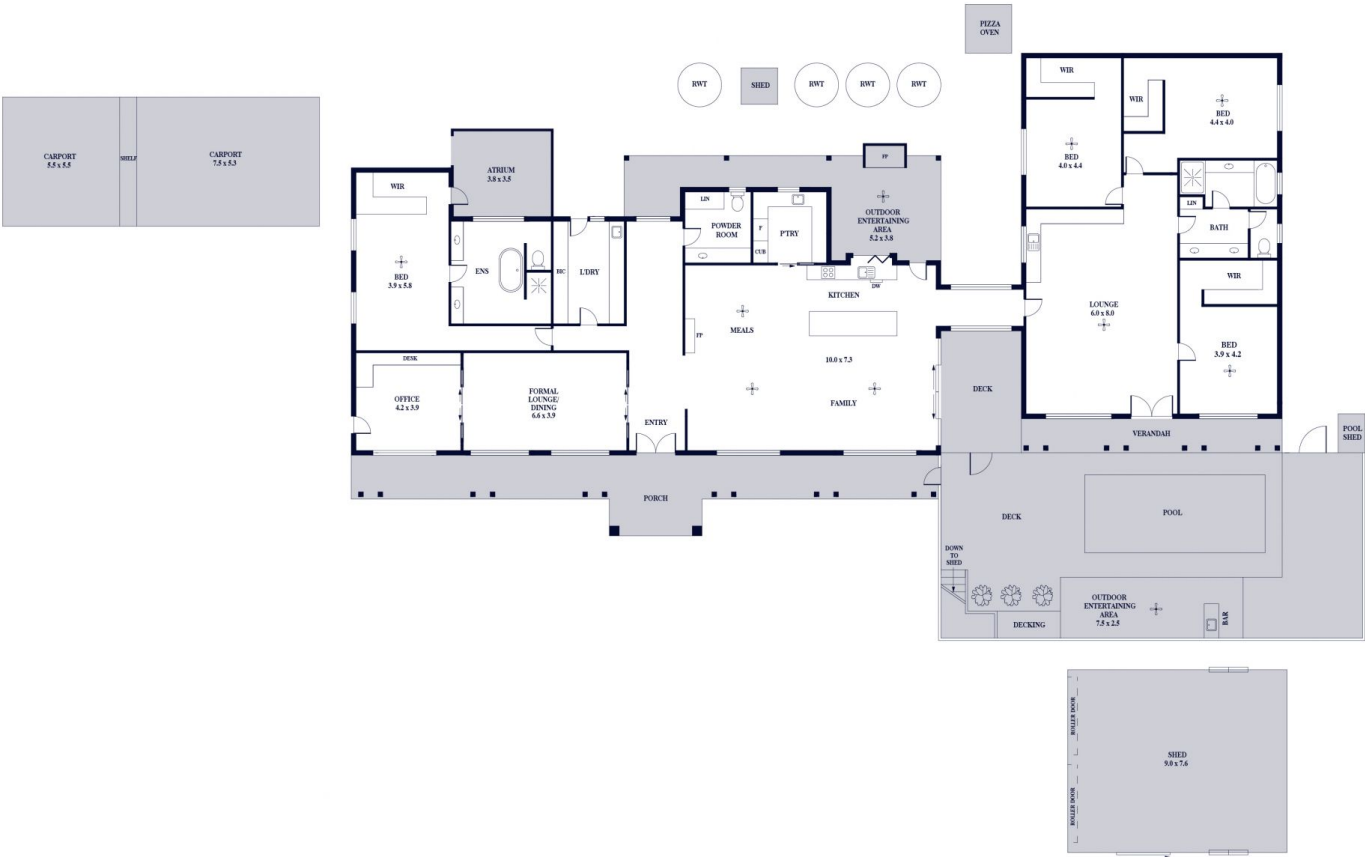

Internal - 412.3 SQM
External - 282.2 SQM
Total - 694.5 SQM

