

### 3A Kelvin Avenue Clarence Park SA

4 2 3

The home's central spine effortlessly connects the rooms and living spaces, blending functionality with contemporary design. Masterfully crafted by Aria Homes, this residence is designed to inspire a low-maintenance, relaxed lifestyle.

Stepping through the front door, you are welcomed by a versatile living room that sets the tone for the thoughtful design throughout. This room can be used as a sun-filled retreat for quiet reflection, a home office, or a study.

The ground floor has a luxurious primary bedroom suite, commanding a sizable area to indulge and retreat. The suite boasts a two-sided custom dressing room leading to an opulent ensuite. Every detail has been carefully curated, from the oak vanity and grand walk-in shower to the

**Type** : House  
**Land Size** : 452 sqm  
**View** : <https://www.alexanderrealestate.com.au/sale/sa/southern-suburbs/clarence-park/residential/house/8243158>

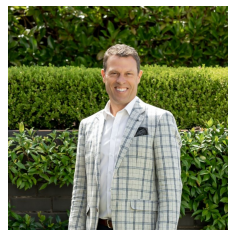

**Steve Alexander**  
0411 755 985

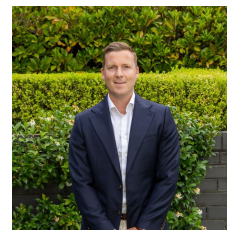

**Jake Tidmarsh**  
0411 221 273

[For full version visit the website](https://www.alexanderrealestate.com.au)

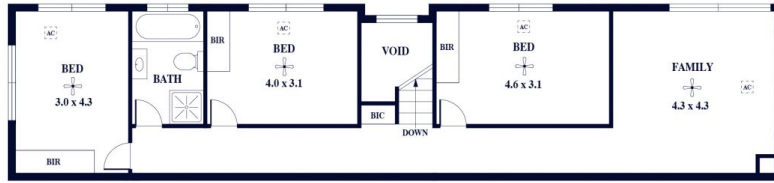

FIRST FLOOR

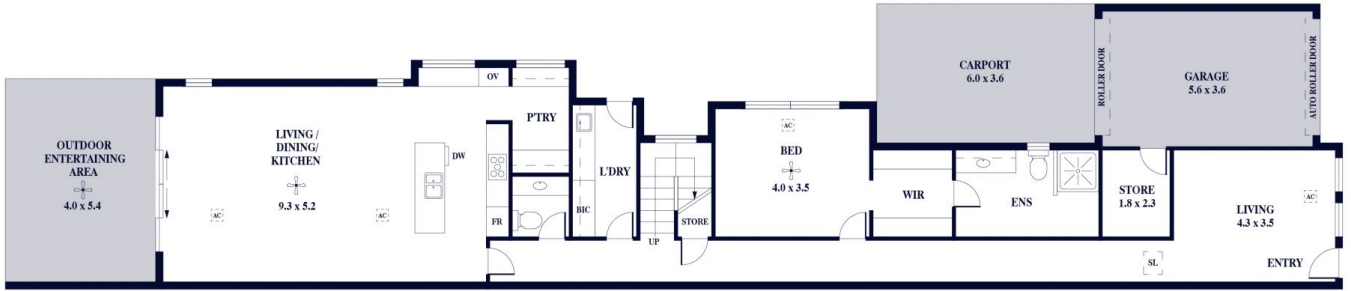

Internal - 267.8 SQM  
 External - 43.2 SQM  
 Total - 311.0 SQM

