

31 Annesley Avenue Trinity Gardens SA

3 🏠 1 🚗

- Featuring three spacious double bedrooms, all boasting high ceilings and polished floorboards
- A separate sitting room with a cozy combustion heater provides a warm and inviting living space
- The kitchen and bathroom positioned at the rear of the home, offering potential for modern upgrades
- A large garage with power and a concrete floor, adding convenience and versatility
- Zoned for the popular Trinity Gardens Primary and Marryatville High Schools

With a 20m (approximately) frontage, the block provides ample width on either side of the home-perfect for future extensions. An incredible chance to craft your dream family home in this highly sought-after eastern suburb's location!

[For full version visit the website](#)

Type : House
Land Size : 889 sqm
View : <https://www.alexanderrealestate.com.au/sale/sa/eastern-suburbs/trinity-gardens/residential/house/8321739>



Penny Riggs
0439669965



Isabela Klemich
0405 412 427

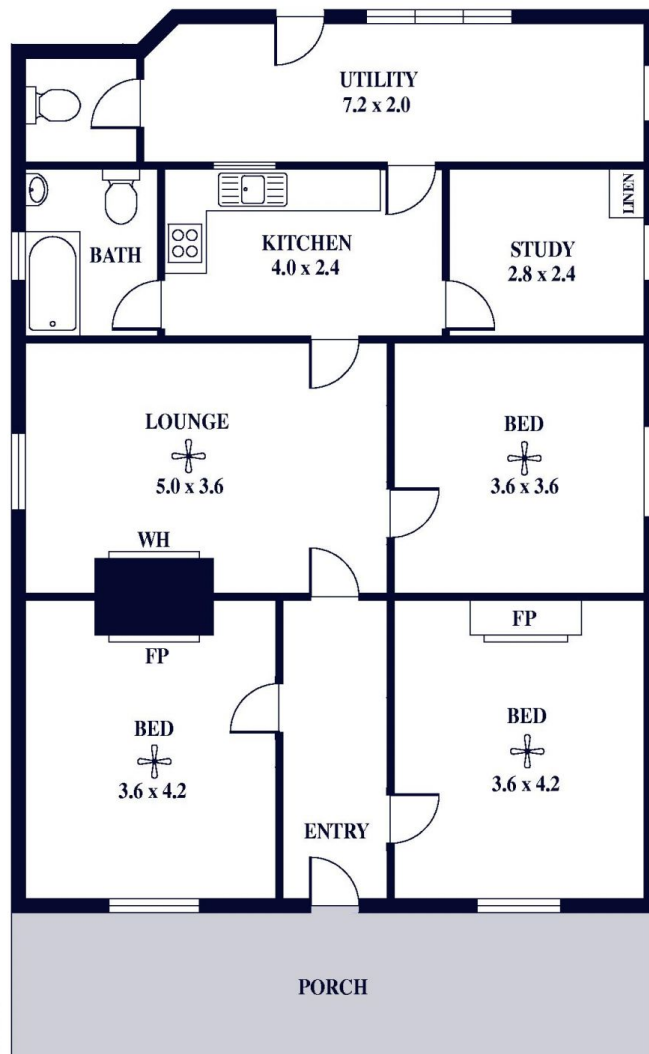
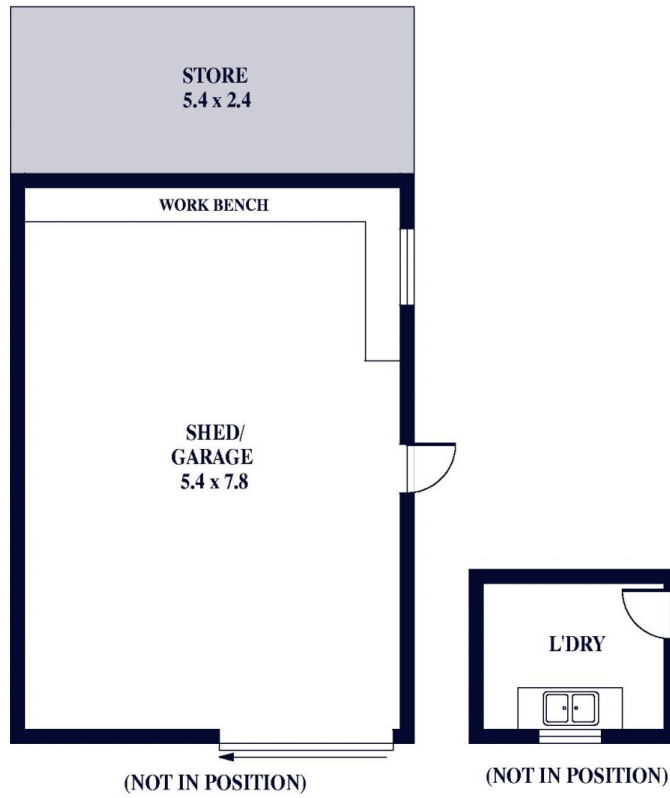

Internal - 119.9 SQM
 External - 82.1 SQM
 Total - 202.0 SQM